

Federal Reserve Bank of Richmond
701 E. Byrd Street
Richmond, VA



Driving Directions

A.

From the South

Take I-95 North to Exit 74-A, Downtown Expressway (I-195). Take the Downtown Expressway to the exit for Canal Street. Follow Canal Street to 5th Street. Turn left on 5th Street and continue approximately two blocks, crossing over Byrd Street. Proceed to Step B.

From the North

Take I-95 South to Exit 75 (64 East). Immediately take the 3rd Street Exit (also Coliseum). Follow 3rd Street to Byrd Street. Turn left on Byrd Street. Turn right on 5th Street. Proceed to Step B.

From the East

Take I-64 West to Exit 190, 5th Street Exit. Follow 5th Street crossing over Byrd Street. Proceed to Step B.

From the West

Take I-64 East to Exit 186, Downtown Expressway (I-195). Take the Byrd Street/2nd Street Exit. Follow Byrd Street and turn right on 5th Street. Proceed to Step B.

B.

Make first left onto Bragg Street and then make an immediate left to enter the parking deck. Press the red button to announce yourself and Law Enforcement will pass you through the gate. After parking car on level P6, take elevator or stairs down to level P1 and exit. Note: The elevator is located in the southeast corner of the parking deck and is accessible from levels P1-P5 only.

After exiting the parking deck, walk toward 7th Street and enter the Bank's side entrance. Bank staff will be positioned to assist you with screening and escorting you to your destination.

Important Notes: All visitors must present a picture ID to Security prior to entering the building. All persons entering the building are subject to metal detection. When you exit the building and return to the parking deck, go to the double doors on Bragg Street and press the red button to the right of the doors for entry.

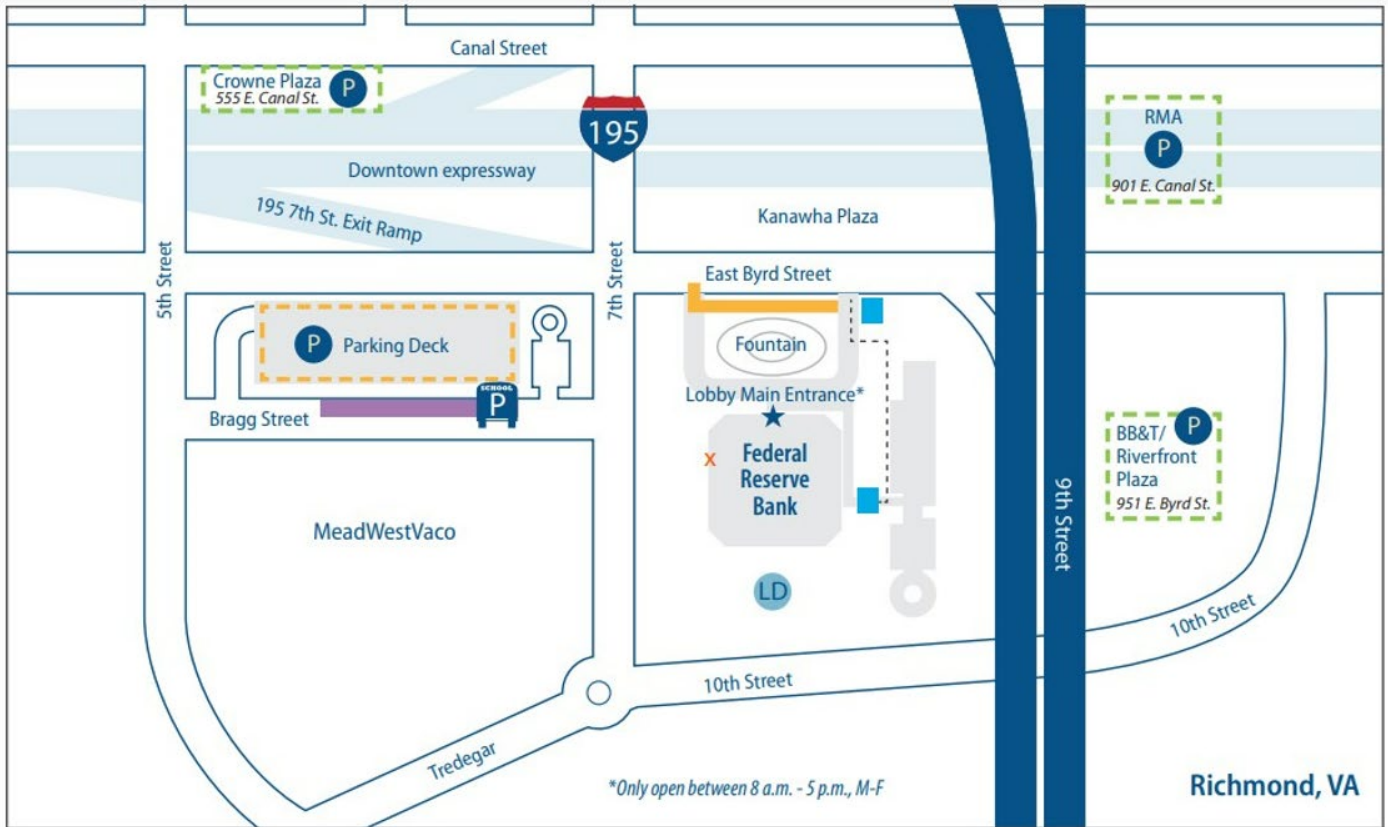

*Only open between 8 a.m. - 5 p.m., M-F

Richmond, VA



701 East Byrd St.
Richmond, VA 23219

Map Legend

- P Parking
- Visitor screening
- ★ Entrance
- Bus/taxi passenger drop off
- Bus parking
- P Public parking
- P Permit only parking
- × 7th Street Entrance
- LD Loading dock